



green oak in construction

peter ross

christopher mettem

andrew holloway

NEW from TRADA Technology

green oak in construction

An illustrated technical guide to the use of oak in modern structures

Peter Ross, Christopher Mettem and Andrew Holloway

NEW

www.trada.co.uk/bookshop



Forestry Commission



green oak in construction

Written by Peter Ross (ARUP), Christopher Mettem (TRADA Technology) and Andrew Holloway (Green Oak Carpentry Company)

Green oak in construction is a four-colour technical guide to the use and performance of oak in modern structures.

Aimed at designers, specifiers and engineers, the book describes the whole process of designing a building based on a green oak frame and explains how the frame will behave over time. It also includes:

- ▶ Eleven case studies
- ▶ Numerous colour photographs and instructive diagrams
- ▶ Comprehensive information on specifying green oak
- ▶ Design data and grading rules

Oak frame is capable of being weatherproofed and insulated in accordance with present-day regulations, and there are significant environmental advantages, which make it attractive to use in a contemporary context.

Published by TRADA Technology, and supported by the Forestry Commission and Scottish Enterprise, **Green oak in construction** features eleven case studies demonstrating best practice and inspirational design in public, commercial and domestic structures:

Stirling Castle Roof ▶ New roof to the South Transept of York Minster ▶ Darwin College, Cambridge ▶ National Maritime Museum (cladding) ▶ Globe Theatre, London ▶ The Downland Gridshell ▶ Bedales School, Olivier Theatre ▶ Abingdon School Boathouse ▶ Mill O'Braco (house) ▶ Bridges.

The publication provides advice and encouragement to all those engaged in a thriving sector of the building industry.

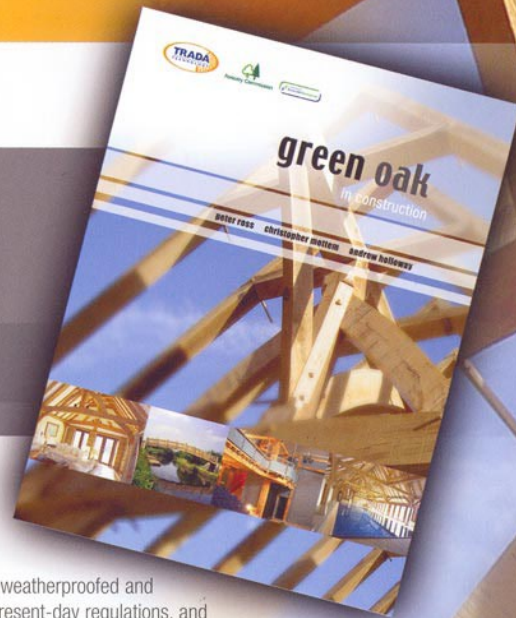

Contents

- ▶ Introduction ▶ Green oak past and present ▶ The supply of green oak
- ▶ The properties of oak ▶ Design of green oak structures
- ▶ The green oak framing process ▶ Enclosing green oak structures
- ▶ Exterior uses of green oak ▶ Case studies on: Historic reconstruction; Traditional models; Modern frames; Innovative frames and Exterior uses.
- ▶ **Appendix I** Specifying oak for traditional framing
- ▶ **Appendix II** Green oak strength grading rules
- ▶ **Appendix III** Engineering design data

Price

- ▶ TRADA members - £45.00 + P&P
- ▶ Non-members - £65.00 + P&P

ISBN 978-1-900510-45-5
January 2007

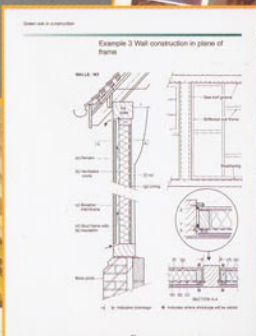

View sample pages of **Green oak in construction** and a selection of colour photographs featured in the book, along with further information at www.trada.co.uk/greenoakinconstruction

RECENTLY PUBLISHED

Timber decking

The professional's manual (2nd edition)

Recommended by the Timber Decking Association, **Timber decking** provides industry professionals with guidance on the design and construction good practices necessary to ensure deck longevity and desired performance.

The 80-page publication includes more than 50 diagrams, drawings and photographs.

Price

- ▶ TRADA members - £20.00 + P&P
- ▶ Non-members - £30.00 + P&P

ISBN 978-1-900510-52-3
October 2006

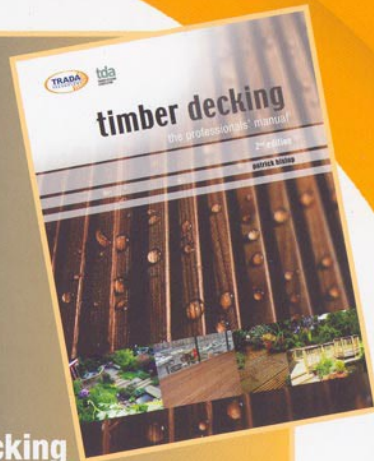

NEW

SPECIAL OFFER

Free postage if you purchase both **Green oak** and **Timber decking** at the same time – a saving of up to £14.25



ORDERFORM

PUBLICATION TITLE	PRICE (£)	QUANTITY	TOTAL (inc. postage)
Green oak in construction	<input type="checkbox"/> TRADA member £45.00 + £6.75 P&P <input type="checkbox"/> Non-member £65.00 + £9.75 P&P		
Timber decking	<input type="checkbox"/> TRADA member £20.00 + £3.00 P&P <input type="checkbox"/> Non-member £30.00 + £4.50 P&P		
Special offer Both Green oak and Timber decking (free postage)	<input type="checkbox"/> TRADA member £65.00 – free P&P <input type="checkbox"/> Non-member £95.00 – free P&P		
		TOTAL (£)	

CONTACT DETAILS

Contact name: _____
 Company: _____
 Delivery address: _____

 Postcode: _____ Telephone no: _____
 Email: _____

PAYMENT DETAILS

We accept payment by cheque or credit card

Cheque Please make cheques payable to "TRADA Technology Ltd".

Credit card details VISA MasterCard Switch

Card no.

Expiry date 3 digit security code Issue no (Switch only)

Signature _____

Name of cardholder _____

Please attach cardholder's address if different from above.

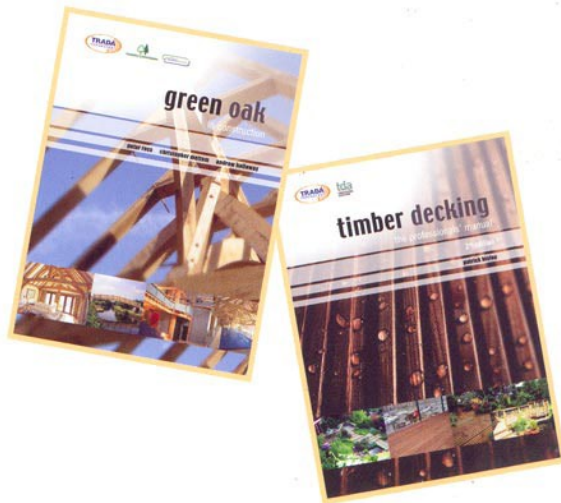

ORDER ONLINE

www.trada.co.uk/bookshop

(special offer cannot be purchased online)

Please complete this form and return by post: TRADA Information Centre,
 Stocking Lane, Hughenden Valley, High Wycombe, Bucks, HP14 4ND
 fax: +44 (0) 1494 565487 telephone: +44 (0) 1494 569602

